



Shrewsbury Flower Show

HOME & CRAFT APPLICATION

Contact Details	
Company Name:	
Contact Name:	
Email Address:	
Contact Number:	
Address:	
Postcode:	
Website:	
Description of your business:	

Marketing & Website information.

Please provide any information listed below, these details will be used on any Website/Social Media & Show related documentation.

If you have hi-res images you'd wish us to use, please email

marketing@shrewsburyflowershow.org.uk with your business name in the subject - by providing this information, you're giving us rights to use these images to promote your business as above.

Social Media Contacts	
Facebook:	
Instagram:	
Twitter:	



Shrewsbury Flower Show

Shropshire Horticultural Society
 VAT Reg. No. 159 7500 42
 Registered Charity 501564

Craft & Home Hall Position	Alternative 1	Alternative 2

Foodhall Stand Sizes	Prices (ex VAT)	Prices (inc VAT)	Quantity & Total
2m x 2m Standard	£245	£294	
3m x 2m Standard	£365	£438	
4m x 2m Standard	£485	£482	
2m x 2m Premium	£265	£318	
3m x 2m Premium	£385	£462	
4m x 2m Premium	£505	£606	
CUSTOM STANDARD	£60pm2	£72pm2	
CUSTOM PREMIUM	£65pm2	£78pm2	

Standard sites are open to trading on one side whereas Premium sites are open to trading on two

Please attach the below paperwork:	Tick if attached:
Risk Assessment	
Fire Risk Assessment	
Proof of Public Liability Insurance min £5million	

sides.

Additional Trader Badges	Quantity	Total
£20 each inc. VAT		

Tables	Quantity	Total
£20 each inc. VAT		

By signing, you agree that you have read and understood the Terms and Conditions as laid out in the Trader Handbook and will abide by them.

<https://shrewsburyflowershow.org.uk/be-part-of-the-show/trade-stands/>

Signed:

Date:

CRAFT & HOME HALL MAP 2025

*Please note that we reserve the right to move a stand location.

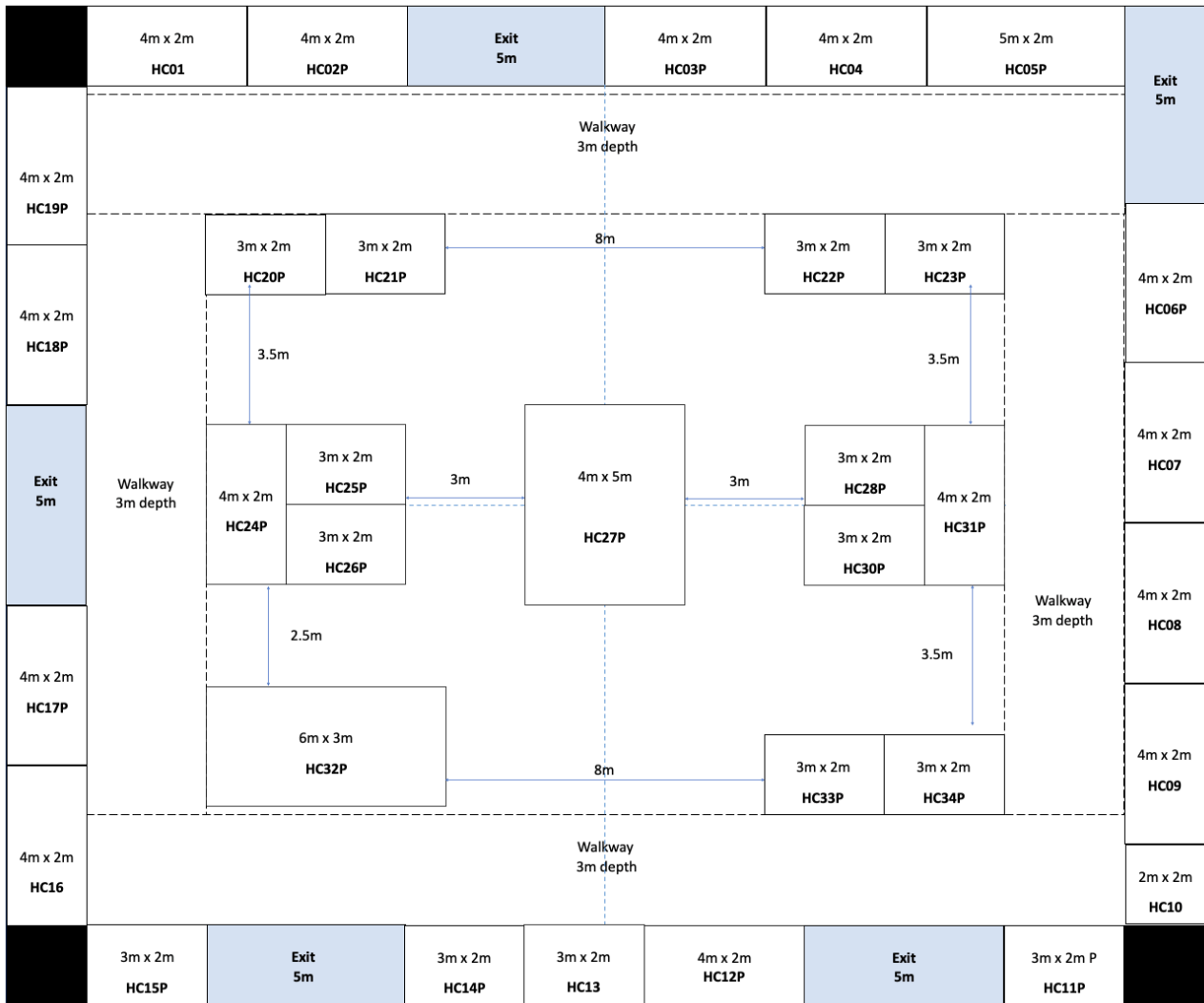

THE MARQUEE Will be available for setting-up from 09.00 – 19.00hrs on Thursday prior to the Show. Any Traders wishing to commence before then must obtain prior permission from the Trade Site Events Administrator. If set up is not possible for a trader until the Friday morning then the trader needs to request this in writing before 31st July 2024, and set-up needs to be completed by no later than 08.00hrs.

On arrival all Traders should report to the marquee steward. The stand must be cleared no later than 12 noon on the Sunday after the Show. The Society accepts no responsibility for any equipment, items or stock left on site at any time.

